

PH03 Comfort XL™

Assembly Instructions and Parts Listing

USA PATENTS: 4,577,351, 4,637,299, 4,793,100, 4,831,671, 4,895,400, 4,918,765
Des. 304,082 CANADIAN PATENT: 1311898

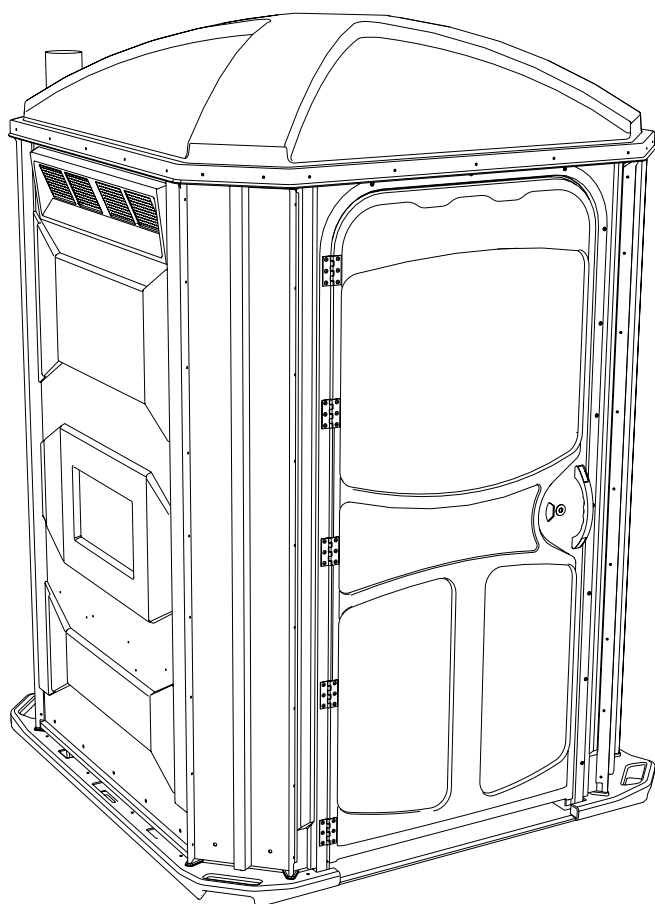

SPECIFICATIONS

DIMENSION	IMPERIAL	METRIC
Exterior Height	91 in	231 cm
Exterior Width	62 in	157 cm
Exterior Length	62 in	157 cm
Door Frame Height(I.D.)	74 in	188 cm
Door Frame Width(I.D.)	32 in	81 cm
Tank Seat Height	19 in	48 cm
Weight	240 lb	108 kg
Static Tank Capacity	33 gal	125 L
Recirc Tank Capacity	22 gal	83.6 L
Side Panel Decal Area	12" x 23"	30cm x 58cm
Door Panel Decal Area	27" x 27"	68cm x 68cm

We recommend reading through the entire Assembly Instructions prior to proceeding with installation, service or maintenance. All references to left and right throughout this guide are as viewed from the front.

POLYJOHN USA

PolyJohn Enterprises Corp
2500 Gaspar Ave.
Whiting, IN 46394
Phone: 800-292-1305
Fax: 219-659-0625
www.polyjohn.com
info@polyjohn.com

POLYJOHN WORLDWIDE

PolyJohn (UK) Ltd.
Equinox 1 Audby Lane
Wetherby, England LS22 7RD
Phone: 44 (0) 1937-583333
Fax: 44 (0) 1937-583322
sales@polyjohn.co.uk

POLYJOHN CANADA

PolyJohn Canada
P.O. Box 2300
199 Forest Plain Rd.
Orillia, Ontario LV3 6S2
Phone: 800-465-9590
Fax: 705-325-8250
info@polyjohncanada.ca

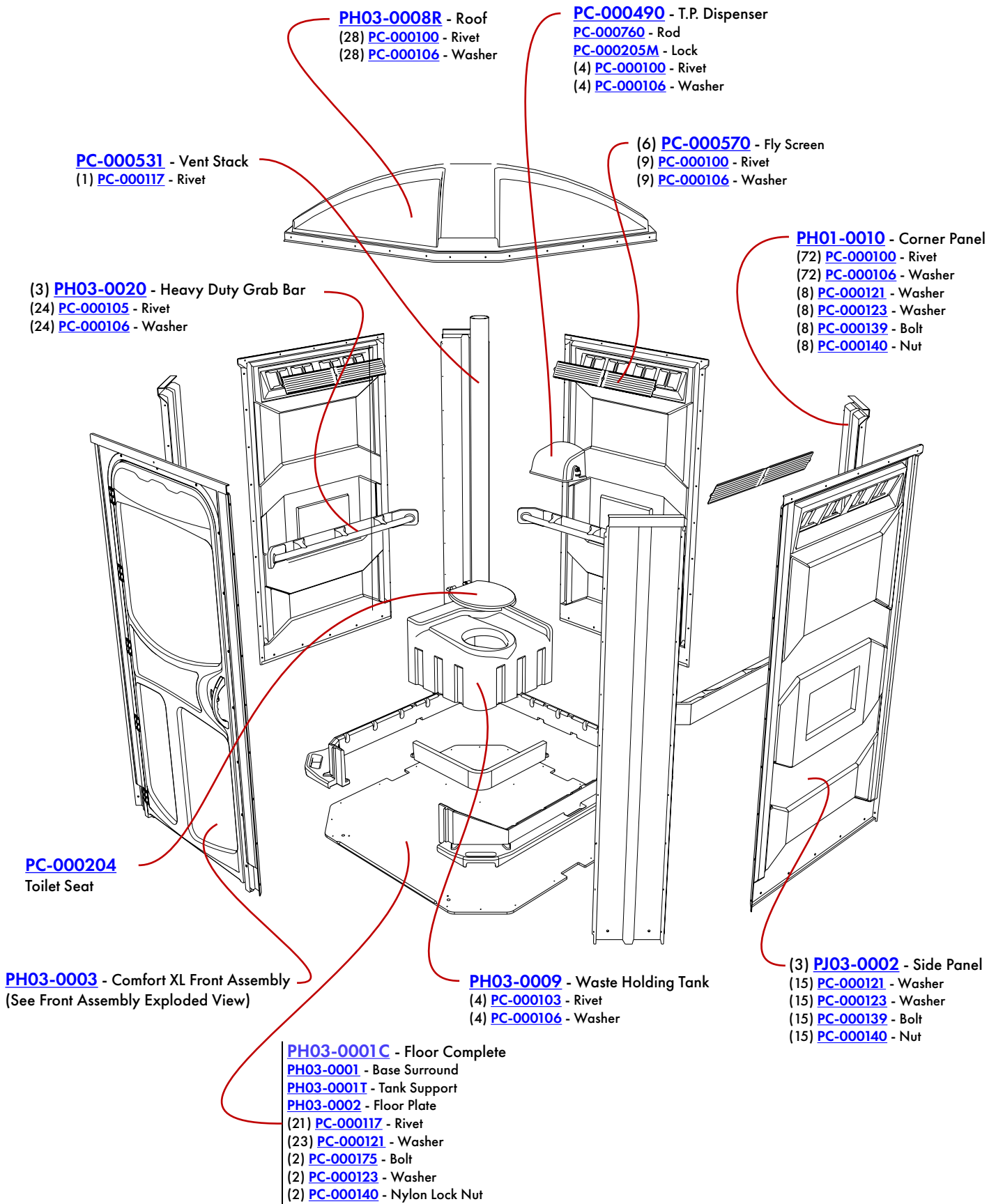

PH03-0003 - Front Assembly

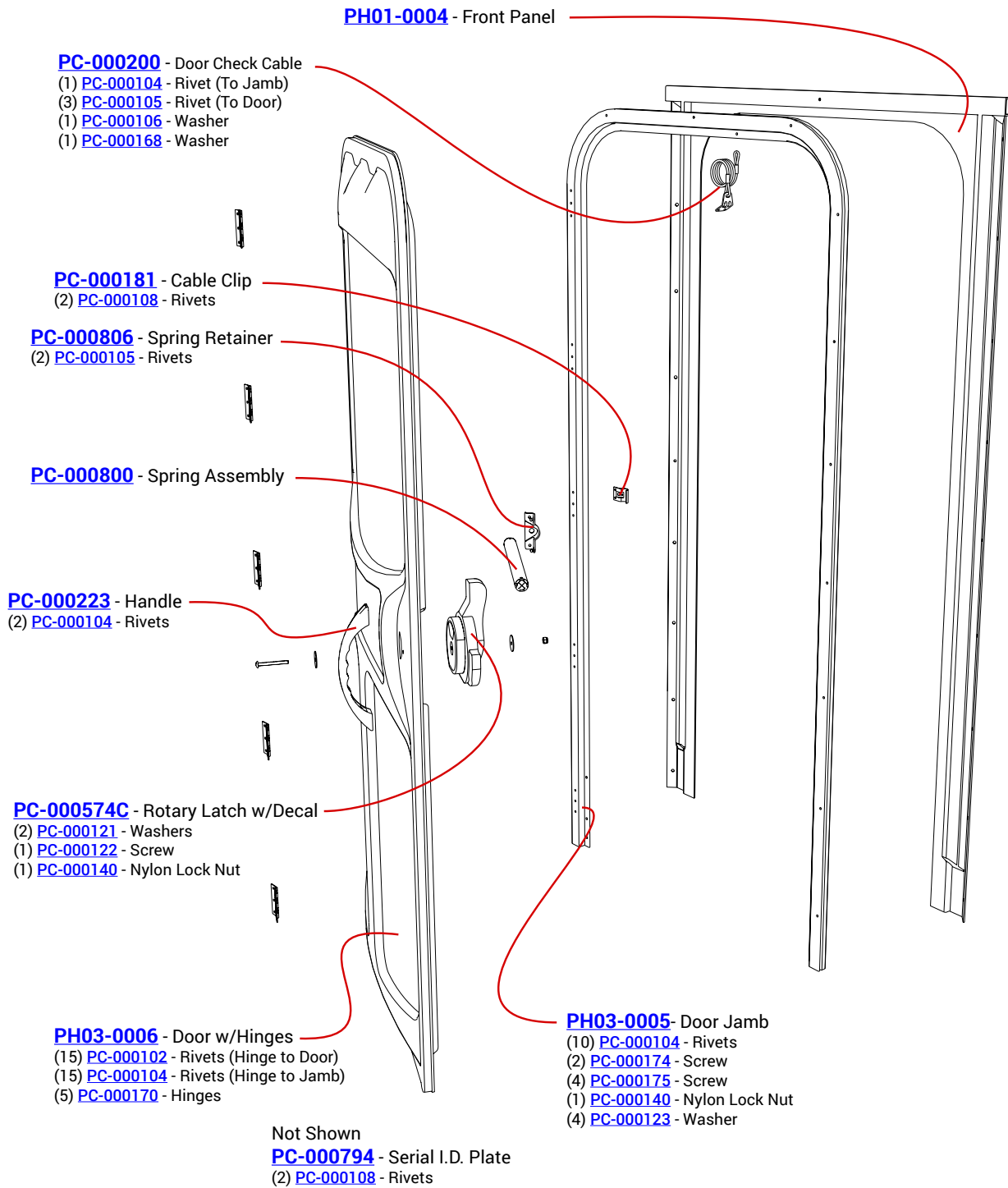

Optional Recirculating Flush System - Exploded View

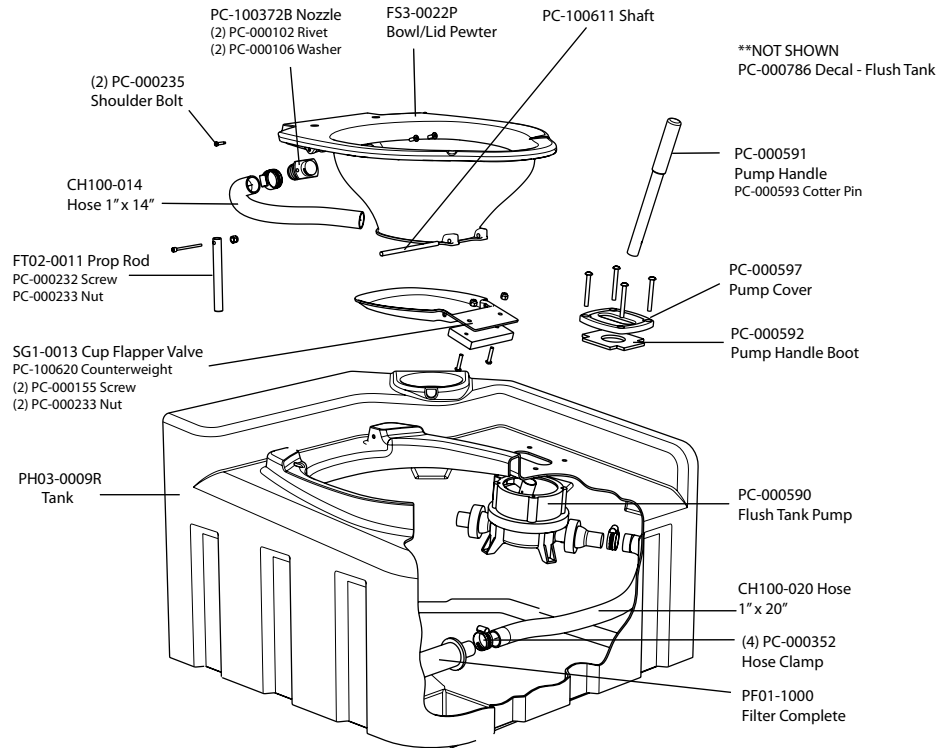

GENERAL OVERVIEW

- Please follow directions in the sequence they are presented. It is suggested you read through the entire assembly instructions prior to proceeding.
- Proper handling is required, especially structures that have flat floors with minimal foundations. Dropping this unit during transport and site set-up may cause structural damage or misalignment of the front assembly and door.
- Position on clear level ground, shims may be used under the floor to aid in leveling, or the door may be out of alignment.
- The **PH03 Model** restroom assembly will require two people.
- All drilling with 13/64" and 1/4" drill bits. All rivet holes drilled 13/64" dia.
- All references to left, right, front and rear throughout the entire assembly instructions are as viewed from the front of the restroom.

~~Tools Required for Assembly~~

- | | | |
|---------------------------------|----------------------------------|-------------------------------|
| • 13/64" Drill Bit | • 1/4" Drill Bit | • Tapered Awls |
| • Rivet Gun w/ 3/16" nose piece | • Phillips & Slotted Screwdriver | • Hammer |
| • Tape Measure | • (2) 7/16" Wrenches | • Vise-Grips (Locking Pliers) |

FULL SIZE SCALE FASTENER DRAWINGS

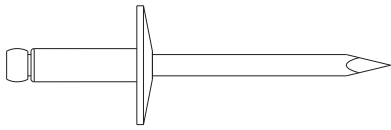

(113) PC-000100 Rivet
Large Flange, Short

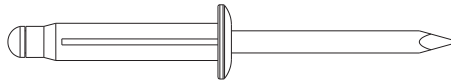

(31) PC-000105 Rivet
Small Flange

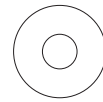

(144) PC-000106
Washer
3/16" Back-up

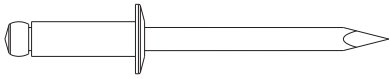

(2) PC-000102 Rivet
Small Flange, Short

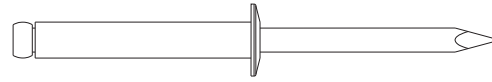

(1) PC-000107 Rivet
Small Flange, Extra Long

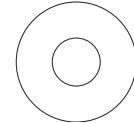

(29) PC-000123 Washer
1/4" x 5/8" Flat

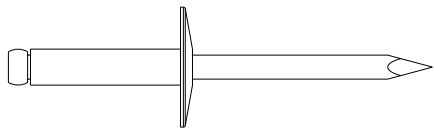

(4) PC-000103 Rivet
Large Flange

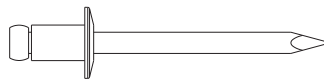

(2) PC-000108 Rivet
Small Flange, Extra Short

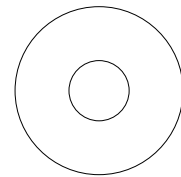

(1) PC-000168 Washer
5/16" x 7/16" Flat

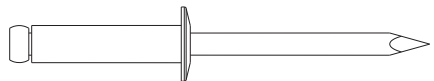

(5) PC-000104 Rivet
Small Flange, Long

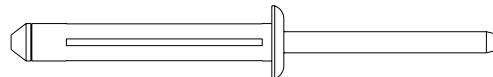

(1) PC-000117 Rivet
Hollow Wall 3/4" Grip

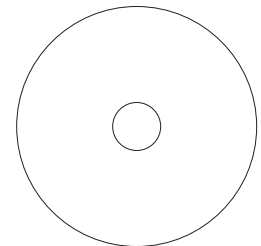

(27) PC-000121 Washer
1/4" x 1-1/4" Fender

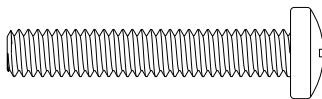

(4) PC-000175 Screw
1/4"-20 x 1-1/2" Phillips

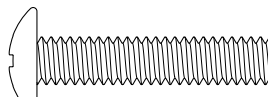

(2) PC-000174 Bolt
1/4"-20 x 1-1/4" Hex Head

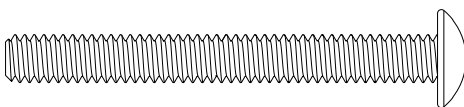

(1) PC-000122 Screw
1/4"-20 x 2-1/4" TrussHead

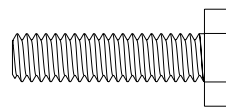

(23) PC-000139 Bolt
1/4"-20 x 1" Hex Head

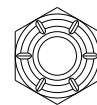

(30) PC-000140
Nut 1/4"-20 Nylok

ASSEMBLY INSTRUCTIONS

Step 1. Three Wall Panels and Four Corner Molding Sub-Assembly

Locate three wall panels and four corner panels. Choose one of the wall panels to be the rear panel and add a corner molding to each side of the rear panel wall using (9) PC-000100 rivets and (9) PC-000106 back-up washers. Rivet in the center holes first, then to the top, and back down to the bottom. Follow this procedure for both of the side wall panels connecting them to both rear corners. Repeat, as well for both of the front corner moldings. **NOTE:** (Make sure to rivet corner moldings from the outside in, this gives a good visual appearance.) Lift the three wall panels and four corner moldings sub-assembly and wrap them around the base, resting the corners on the 1/4" raised areas molded into the top of the base.

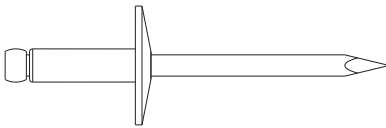
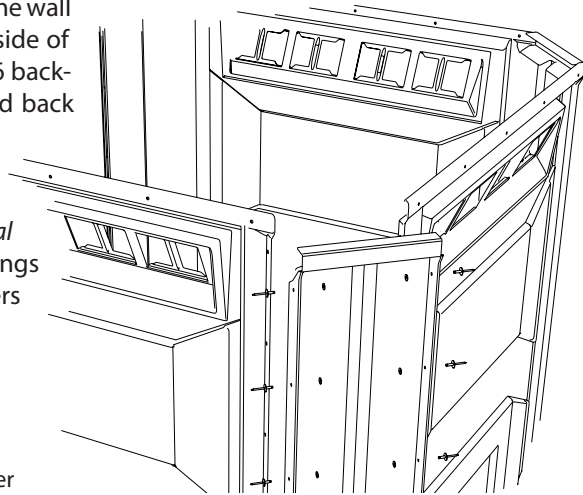

PC-000100 Rivet
54 Used in this step

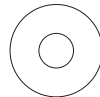

PC-000106 Washer
54 Used in this step

Step 2. Front Sub-Assembly to the Base Surrounds

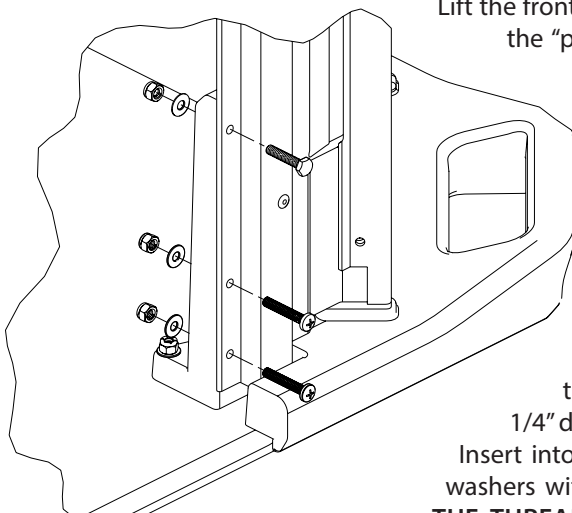

Lift the front sub-assembly and place the legs of the aluminum door jamb into the "pockets" of the base surround on each side of the door opening.

Attach the front assembly to the front corner moldings by riveting into the pre-drilled holes using (18) PC-000100 rivets and (18) PC-000106 back-up washers as in Step 1. **NOTE:** (Make sure that you rivet from the outside of the front toward the corner.) For shipping purposes, there is a zip tie holding the holding the door closed with the front assembly. Cut this tie off and install a PC-000107 rivet into the hole in the door jamb. Grab one side of the front assembly and pull tightly into the "pocket" of the base surround and place a pair of vise-grips onto the base surround holding the front sub-assembly. Locate the three pre-drilled holes in the bottom of the door jamb, using a 1/4" drill bit, drill into those holes all the way through the base surround.

Insert into the two bottom holes (2) PC-000175 screws with (2) PC-000123 washers with (2) PC-000140 lock-nuts. **DO NOT TIGHTEN TO THE END OF THE THREAD, TIGHTEN JUST SO THE LOCK-NUT IS JUST FLUSH AT THE**

END OF THE SCREW. Insert into the top hole (1) PC-000174 bolt with (1) PC-000123 washer and (1) PC-000140 lock-nut. **DO NOT TIGHTEN TO THE END OF THE THREAD, TIGHTEN JUST SO THE LOCK-NUT IS JUST FLUSH AT THE END OF THE SCREW.** Repeat this for the other side of the front sub-assembly.

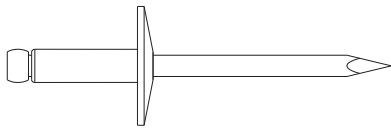

PC-000100 Rivet
18 Used in this step

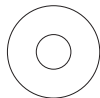

PC-000106 Washer
18 Used in this step

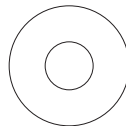

PC-000123 Washer
6 Used in this step

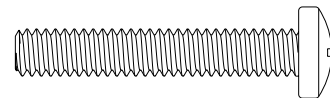

PC-000175 Screw
4 Used in this step

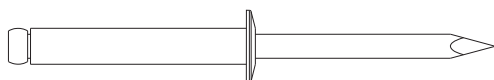

PC-000107 Rivet
1 Used in this step

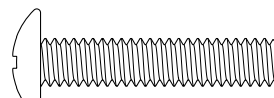

PC-000174 Bolt
2 Used in this step

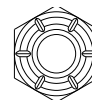

PC-000140 Nut
6 Used in this step

Step 3. Attaching the Wall Panels and Corner Moldings to the Base Surround

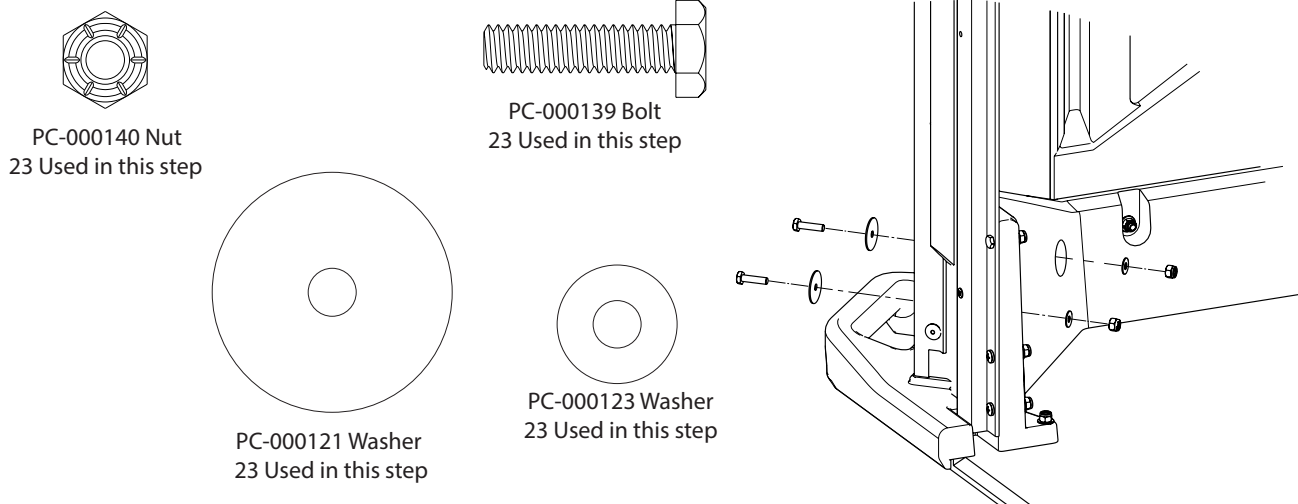

For the side panels: Place a PC-000121 washer on a PC-000139 bolt and insert the bolt through the center hole in the left side panel and into the base surround. Place a PC-000123 washer on the inside along with a PC-000140 nut and tighten. Repeat this step for the other two side panels. Level the left side panel, and using the remaining holes in the side as a guide, drill 1/4" holes all the way through the base surround. Fasten the side to the base using the same method as for the center hole. Repeat this for the rest of the sides. **For the corner moldings:** **NOTE:** *(Be sure the corners are pushed tight against the base surround by pushing the corner at the rib in the center.)* Start with the front corners first. From the inside of the unit, locate the two recesses in the front inside corners of the base surround. Drill a 1/4" hole through the centers of these recesses and through the corner panel. Fasten in place using the PC-000121 washers and PC-000139 bolts on the outside with the PC-000123 washers and PC-000140 nuts on the inside. Tighten in place. Repeat these steps for the remaining corner panels.

Step 4. Roof Assembly

NOTE: *(The front and three wall panels are supplied with pre-drilled holes at the top center of each panel. The roof is supplied with dimple spots along each of the eight edges.)* Use a 13/64" drill bit. Drill holes in the center dimple spots of the roof. **IMPORTANT - BE SURE TO ALIGN THE HOLE FOR THE VENT STACK IN THE ROOF WITH THE HOLE IN THE TANK.** **Start with the front of the unit:** The roof needs to be aligned with the center hole in the jamb. When aligning the roof to the front assembly, apply pressure to the left corner molding, this will cause the door to move up and down within the aluminum door jamb. Before installing the rivets in this area square up the door to the jamb. Someone on the outside will rivet PC-000100 rivets through each of the four center holes of the roof to the wall panels, while another person places PC-000106 back-up washers on the rivet stems from inside the unit. **Proceed with the corner moldings:** Using a 13/64" drill bit, drill holes in the center on both sides of the rib and then rivet into place as above. **For the wall panels:** Hold the roof firmly against the wall panels. Using a 13/64" bit, drill through the remaining dimple spots of the roof into the wall panels. The person on the outside will again rivet the PC-000100 rivets through the drilled holes, while from inside, someone will place PC-000106 back-up washers on the rivet stems.

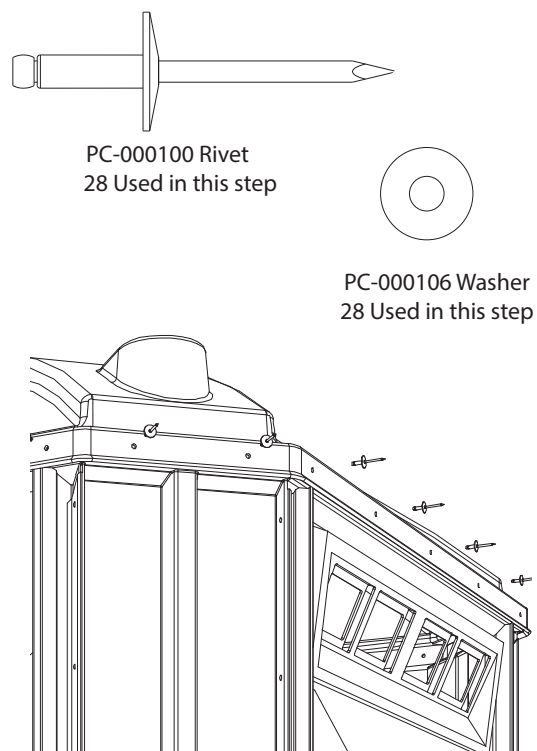

Step 5. Waste Tank Installation

On the outside of the unit someone will measure and mark drill spots. For the rear wall panel measure from the inside edge of the rib in 11" and up from the top of the base surround 17-1/2" and mark with a marker. For the corner molding measure in the center of each side of the rib and up from the top of the base surround and mark at 19". On the left wall panel measure from the inside edge of the rib in 11" and up from the top of the base surround and mark at 19". Position the waste tank in the left rear corner on the tank supports of the base surround. While inside one person pushes the tank against the wall panels and corner, using a 13/64" bit, someone on the outside will drill through the four spots just marked. **CAUTION: WHEN DRILLING HOLES, ESPECIALLY THE REAR PANEL, BE SURE TO DRILL ONLY THROUGH THE FIRST WALL OF THE TANK.** Rivet into the holes using (4) PC-000103 rivets from the outside with (4) PC-000106 back-up washers on the inside of the tank.

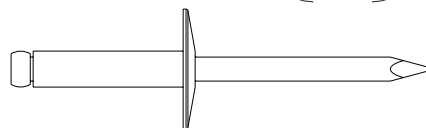
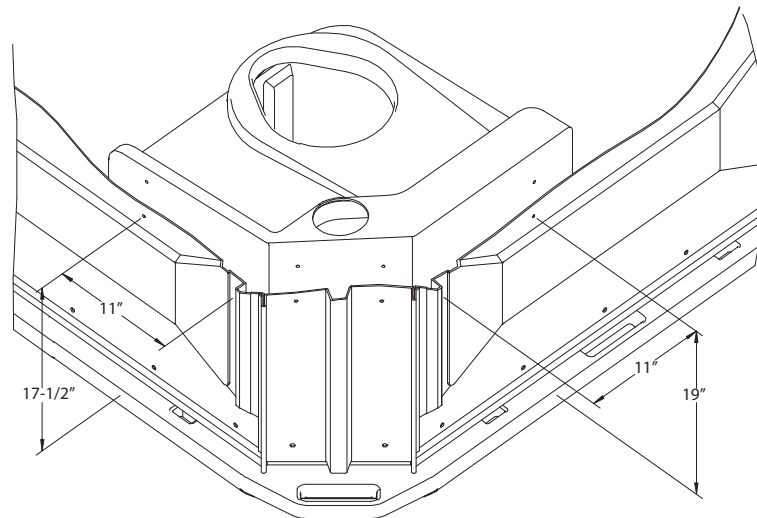

PC-000103 Rivet
4 Used in this step

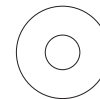

PC-000106 Washer
4 Used in this step

Step 6. Fly Screen Installation

Each of the three sidewall panels has two vent screens. On the surface of each screen there is a date stamp symbol. The symbol goes toward the center of the sidewall panel, facing the inside. For each of the sidewalls, insert into the vent slot one screen from each side and overlap the center holes of the screens (at the date stamp symbol). **IMPORTANT - MAKE SURE BOTH SCREENS ARE CENTERED IN THE VENT SLOT.** From inside the unit using a 13/64" drill bit, drill a hole through the center hole of the screen and into each of the side walls. From the outside rivet a PC-000100 rivet into the center hole with a PC-000106 back-up washer on the inside. From inside the unit using the holes at the ends of the screens as guides, drill holes through to the wall panels. From the outside rivet the screens in place with PC-000100 rivets and PC-000106 back-up washers on the inside.

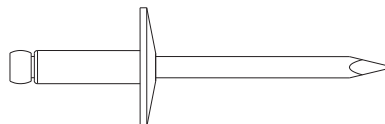
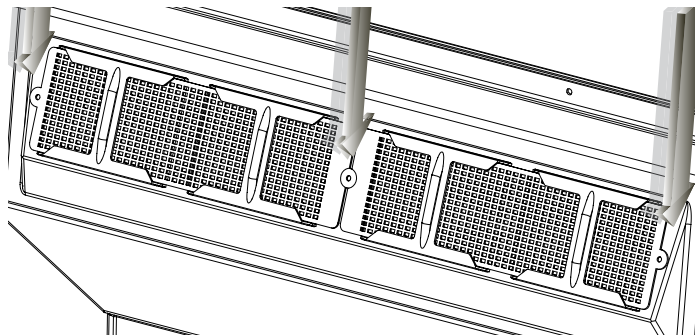

PC-000100 Rivet
9 Used in this step



PC-000106 Washer
9 Used in this step

Step 7. Grab Bar Mounting Locations

To mark the holes to mount the right side grab bar, use the diagram to the right as a reference, and mark the mounting hole locations as shown. There are a total of 8 hole locations for each grab bar. Five (5) of the holes are located at a height of 32-1/4" from the top of the base surround, and three (3) holes at a height of 30-1/4". The hole locations on the corner panels are located halfway between the center rib and the corner/side connection. Repeat this for the rear and left panel grab bars. Using a drill with a 13/64" drill bit, drill holes in the locations just marked.

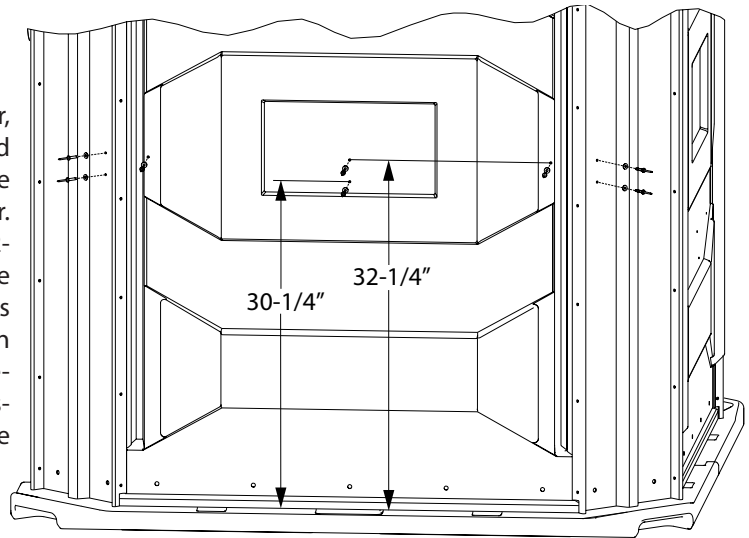

Step 8. Grab Bar Installation

On the inside of the right side panel, measure and position the bottom of the grab bar at 26-1/2" up from the top of the base surround. The bottom of the grab bar should be even with the bottom edge of the rectangular boss in the middle of the side panel. With one person holding the grab bar in place on the inside of the unit, have another person drill the eight 13/64" diameter holes through the holes drilled in the previous step.

Be sure to drill through only one wall of the grab bar.

Place (8) PC-000106 Back-Up Washers on (8) PC-000105 rivets, and rivet the grab bar in place. Repeat this step for the rear and left panel grab bars.

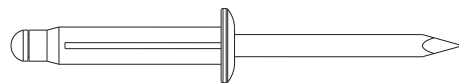
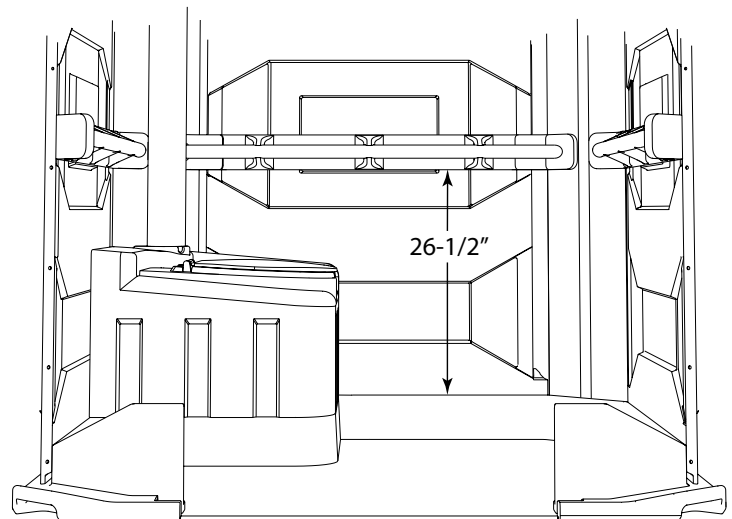

PC-000105 Rivet
24 Used in this step

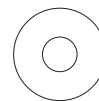

PC-000106 Washer
24 Used in this step

Step 9. Vent Stack Installation

Slide the vent stack up through the 4" hole of the roof and down into the corresponding hole in the tank. Using a 13/64" drill bit, drill a hole through the boss on the tank and through the vent stack. Rivet into place with (1) PC-000117 rivet.

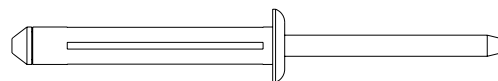

PC-000117 Rivet
1 Used in this step

Step 10. Door Handle and Rotary Latch

Mark the hole locations on the front of the door for the door handle by measuring up from the bottom of the door by 31-1/2" and measuring in from the side of the door by 1". This is the location for the bottom mounting hole. Using a drill with a 13/64" drill bit, drill a hole through ONLY THE OUTSIDE WALL of the door. Rivet the door handle to the door using a PC-000105 rivet through the bottom hole of the handle. Making sure the handle is straight on the door, use the very top hole of the handle as a drill guide and drill a 13/64" hole through only the outside wall of the door. Rivet in place using a PC-000105 rivet. To mount the rotary latch, insert the PC-000122 Screw through a PC-000121 washer and into the front of the door. Place the rotary latch, another PC-000121 washer on the end of the screw and fasten in place using a PC-000140 lock nut. Adjust the tightness of the screw to adjust the ease of the latch movement.

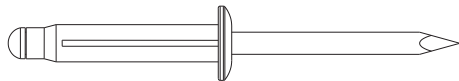
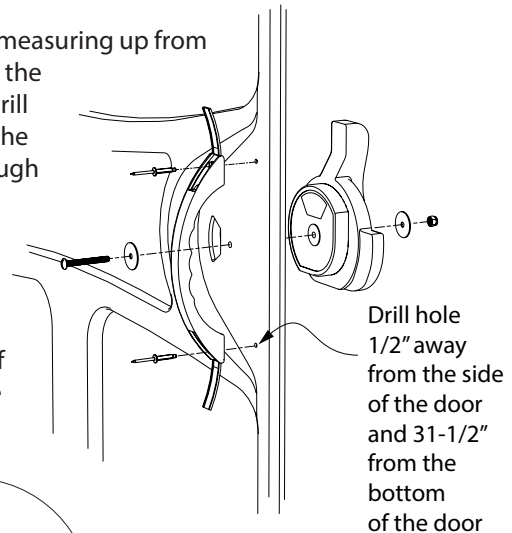

PC-000105 Rivet
2 Used in this step

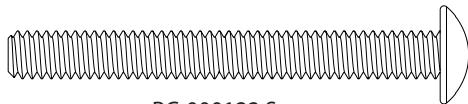

PC-000122 Screw
1 Used in this step

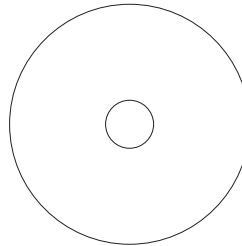

PC-000121 Washer
2 Used in this step

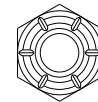

PC-000140 Nut
1 Used in this step

Step 11. Door Check Cable

Align the three holes of the metal bracket on the door check cable to the holes in the top inside center of the door so that the bracket angles toward the unit and the three holes line up with the holes in the bracket (*as shown*). Rivet into place using (3) PC-000105 rivets. From the outside of the unit, insert a PC-000104 rivet into the pre-drilled hole at the top of the door opening of the door jamb. Place the looped end of the door check cable on the end of the rivet followed by (1) PC-000168 washer and (1) PC-000106 back-up washer. Rivet in place.

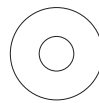
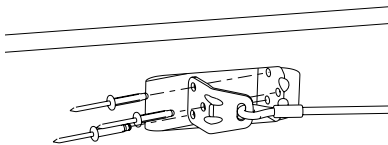

PC-000106 Washer
1 Used in this step

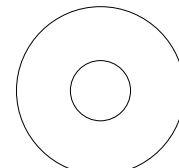

PC-000168 Washer
1 Used in this step

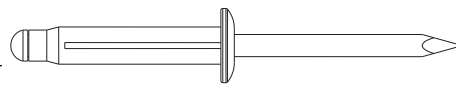

PC-000105 Rivet
3 Used in this step

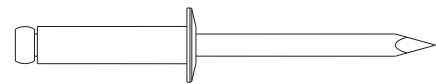

PC-000104 Rivet
1 Used in this step

Step 12. Toilet Paper Dispenser

The double roll dispenser is mounted up on the center of the rear wall panel. Position the dispenser on the bottom edge of the first raised rib directly below the fly screens. Level the dispenser on the wall and use the four holes in the back of the dispenser as a guide to mark the location for drill holes. Drill four 13/64" holes into the drill spots just marked. Use awls to hold the T.P. Dispenser in place. From outside of the unit rivet in place using (4) PC-000100 rivets and (4) PC-000106 back-up washers on the inside.

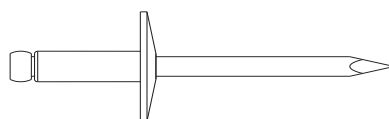

PC-000100 Rivet
4 Used in this step

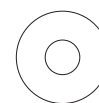

PC-000106 Washer
4 Used in this step

Step 13. Toilet Seat Installation

Place the toilet seat on the top of the tank. Line up the holes in the hinge of the seat with the holes in the top of the tank. Insert the seat bolts through the seat hinge and through the tank. Lift open the seat, thread the plastic seat nuts on the ends of the bolts and tighten.

Step 14. Door Closure Installation

Push the spring tube assembly into the hole in the center molded pocket of the door with the swaged ball end towards the hinged side of the door. Insert the tabs of the door closure retainer clip into the 2 pre-drilled holes as shown below. Pivot the retainer clip into place while feeding the spring cable through the hole in the retainer clip. Rivet into place with (2) PC-000105 rivets. Line up the cable clip in the center of the door jamb to the door closure retainer clip. From inside the unit using a 13/64" bit, drill two holes into one side of the door jamb only. Rivet the cable clip to the door jamb using (2) PC-000108 rivets. On the inside of the unit, place the top of a hammer against the cable clip. Place the ball end of the spring cable in the claw of the hammer. Open the door while holding the hammer in position. Hold the door open with your foot and clamp a vice-grip pliers on the cable where it comes out of the door. **BE SURE TO CLAMP DOWN TIGHT.** Remove the cable from the claw of the hammer, close the door and place the end of the cable into the slot of the cable clip. Open the door and remove the vice-grips.

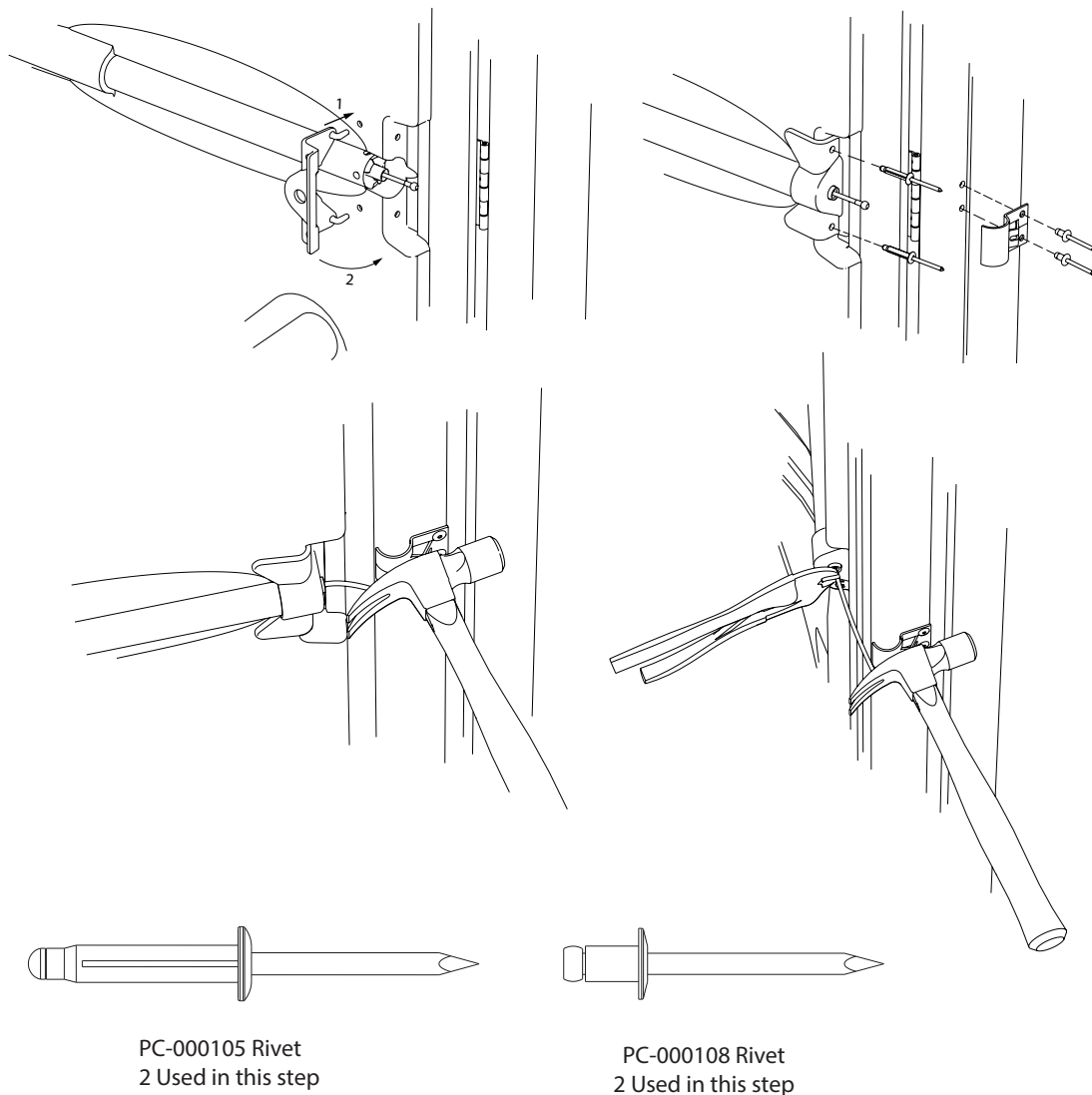

CLEANING AND MAINTENANCE

- Use a mild soap to clean all surfaces and component parts.
- Minor scratches and abrasions can be lightly sanded or scrubbed with a mild abrasive cleaner (*such as "Soft Scrub"*) that contains calcium carbonate, hypochlorate bleach, and detergents. Be sure to follow the cleaning product directions since these ingredients may cause hazardous gases when mixed with other chemicals. Rinse the cleaned areas and buff with a conventional wax.
- Some light scratches may also be hidden by using an industrial hot air gun.
- To keep the interior smelling fresh, spray with a deodorant spray.

For a source of cleaning, deodorizing, and paper products contact:

**POLYJOHN
2500 GASPAR AVE.
WHITING, IN 46394-2175
800-292-1305**

We highly recommend membership in the Portable Sanitation Association International (PSAI); the worldwide authority on portable sanitation services. The PSAI, "Portable Sanitation Industry Certification Program" manual contains a wealth of information of standards and service procedures. For more information contact the PSAI:

PORTABLE SANITATION ASSOCIATION INTERNATIONAL
7800 METRO PARKWAY, SUITE 104
BLOOMINGTON, MINNESOTA 55425 USA
800-822-3020 / 612-854-8300 (FAX: 612-854-7560)
www.psa.org

PolyJohn Enterprises Corporation publishes a series of technical manuals of guides for the Portable Sanitation Association International. Contact your area sales representative for further details.

OUR MISSION STATEMENT

"PolyJohn is a family owned, state of the art, plastics manufacturing company dedicated to providing its employees with a work environment committed to excellence, and its customers with innovative products, services and technology that meet or exceed their requirements."

THANK YOU FOR PURCHASING POLYJOHN PRODUCTS!

Look for us on the Web @ www.PolyJohn.com